

W68PL Male Connector

PART NO.	TUBE SIZE (IN)	PIPE THREAD (NPTF)	C HEX	L	M	FLOW DIA. D
W68PL-2-1	1/8	1/16	3/8	.85	.66	.094
W68PL-2-2	1/8	1/8	7/16	.85	.66	.094
W68PL-2-4	1/8	1/4	9/16	1.08	.66	.094
W68PL-3-2	3/16	1/8	7/16	.90	.63	.156
W68PL-3-4	3/16	1/4	9/16	1.08	.63	.156
W68PL-5/32-2	5/32	1/8	7/16	.85	.67	.125
W68PL-5/32-4	5/32	1/4	9/16	1.10	.67	.125
W68PL-4-1	1/4	1/16	1/2	1.15	.70	.140
W68PL-4-2	1/4	1/8	1/2	.97	.70	.188
W68PL-4-4	1/4	1/4	9/16	1.10	.70	.188
W68PL-4-6	1/4	3/8	11/16	1.14	.70	.188
W68PL-5-2	5/16	1/8	9/16	1.22	.77	.234
W68PL-5-4	5/16	1/4	9/16	1.10	.77	.250
W68PL-5-6	5/16	3/8	11/16	1.10	.77	.250
W68PL-6-2	3/8	1/8	5/8	1.26	.77	.234
W68PL-6-4	3/8	1/4	5/8	1.14	.77	.312
W68PL-6-6	3/8	3/8	11/16	1.09	.77	.312
W68PL-6-8	3/8	1/2	7/8	1.34	.77	.312
W68PL-8-4	1/2	1/4	13/16	1.52	.86	.344
W68PL-8-6	1/2	3/8	13/16	1.31	.86	.344
W68PL-8-8	1/2	1/2	7/8	1.43	.86	.375

68PL-5/32-4LT* 5/32 1/4-28 7/16 .88 .69 .093

* SAE-LT THREADS

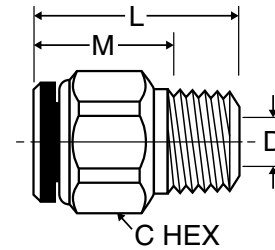

W68PLP Male Connector (Nickel Plated)

PART NO.	TUBE SIZE (IN)	PIPE THREAD (NPTF)	C HEX	L	FLOW DIA. D
68PLP-2-0	1/8	10X32	3/8	.92	.094
W68PLP-2-1	1/8	1/16	3/8	.79	.094
W68PLP-2-2	1/8	1/8	7/16	.79	.094
W68PLP-2-4	1/8	1/4	9/16	1.02	.094
W68PLP-3-2	3/16	1/8	7/16	.85	.141
W68PLP-3-4	3/16	1/4	9/16	1.01	.156
W68PLP-5/32-2	5/32	1/8	7/16	.80	.125
W68PLP-5/32-4	5/32	1/4	9/16	1.03	.125
68PLP-4-0	1/4	10X32	1/2	.96	.094
W68PLP-4-1	1/4	1/16	1/2	1.07	.141
W68PLP-4-2	1/4	1/8	1/2	.89	.188
W68PLP-4-4	1/4	1/4	9/16	1.00	.188
W68PLP-4-6	1/4	3/8	3/4	1.04	.188
W68PLP-5-2	5/16	1/8	9/16	1.18	.234
W68PLP-5-4	5/16	1/4	9/16	1.04	.250
W68PLP-5-6	5/16	3/8	11/16	1.04	.250
W68PLP-6-2	3/8	1/8	5/8	1.21	.234
W68PLP-6-4	3/8	1/4	5/8	1.08	.312
W68PLP-6-6	3/8	3/8	11/16	1.02	.312
W68PLP-6-8	3/8	1/2	7/8	1.28	.312
W68PLP-8-4	1/2	1/4	13/16	1.44	.344
W68PLP-8-6	1/2	3/8	13/16	1.24	.344
W68PLP-8-8	1/2	1/2	7/8	1.35	.375

68PLP-5/32-4LT* 5/32 1/4-28 7/16 .88 .093

*SAE-LTTHREADS

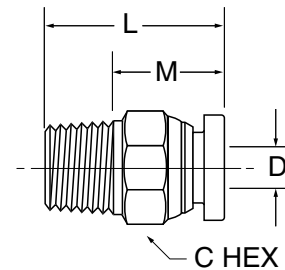

68PLP-10X32

